

Notes

1. Preliminary design has been developed using topographical survey information but presented with OS mapping background to provide further context. As such minor discrepancies between proposals and mapping background may be present.

Key to symbols

	Cycle Track
	Shared Use
	Carriageway
	Bus Lane
	Highway Boundary
	Traffic Sign

Reference drawings

P3	06.07.21	PJC	Drawing Amended	JP	NW
P2	01.07.21	PJC	Preliminary Design Issue	JP	NW
P1	25.06.21	PJC	Draft for Client Comment	XX	XX
Rev	Date	Drawn	Description	Ch'k'd	App'd

MOTT MACDONALD

Mott MacDonald House
8-10 Sydenham Road
Croydon, CR0 2EE
United Kingdom

T +44 (0)20 8774 2000
F +44 (0)20 8681 5706
W mottmac.com

Client

Title

A23 Active Travel Scheme
Preliminary Design
General Arrangement
Sheet 1 of 14

Designed	P. Crowther	PC	Eng check	..	
Drawn	P. Crowther	PC	Coordination	..	
Dwg check	J. Pearson	JP	Approved	N. Wilkinson	NW
Scale at A1	Status	Rev	Security		
1:500	PRE	P3	STD		
Drawing Number					
100103332-MMD-00-XX-DR-HW-0001					

© Mott MacDonald
This document is issued for the party which commissioned it and for specific purposes connected with the captioned project only. It should not be relied upon by any other party or used for any other purpose.
We accept no responsibility for the consequences of this document being relied upon by any other party, or being used for any other purpose, or containing any error or omission which is due to an error or omission in data supplied to us by other parties.
C:\Users\CRO91066\Mott MacDonald\BHC Design and Transport Fram - Acad\DR\103332-MMD-DD-XX-DR-HW-0001 P3 sheet 1 of 14.dwg Jul 6, 2021 - 3:08PM CRO91066

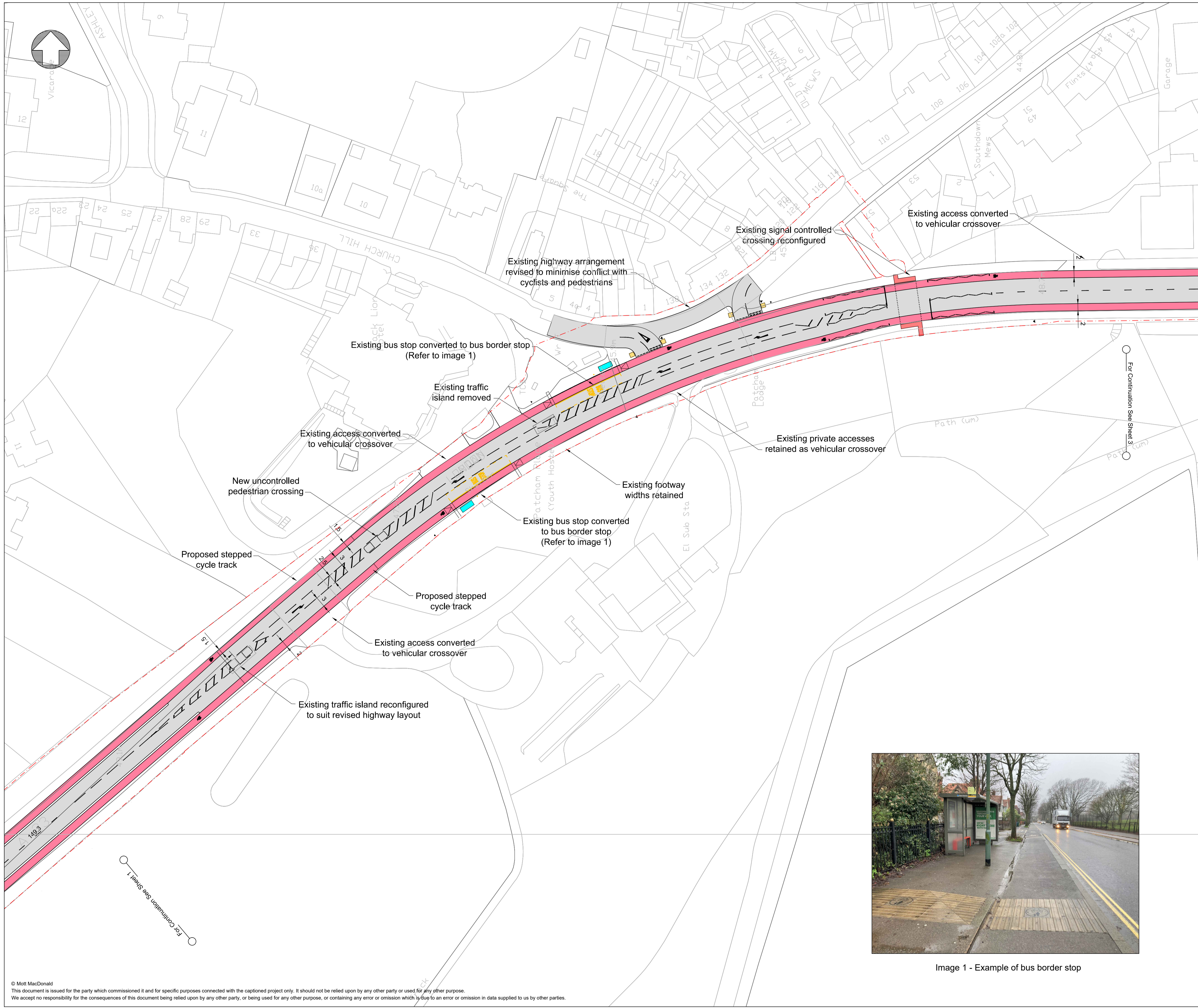

Notes

1. Preliminary design has been developed using topographical survey information but presented with OS mapping background to provide further context. As such minor discrepancies between proposals and mapping background may be present.

Key to symbols

- Cycle Track/Lane
- Shared Use
- Carriageway
- Bus Lane
- Highway Boundary
- Traffic Sign

Reference drawings

P3	06.07.21	PJC	Drawing Amended	JP	NW
P2	02.07.21	PJC	Preliminary Design Issue	JP	NW
P1	25.06.21	PJC	Draft for Client Comment	XX	XX

Rev	Date	Drawn	Description	Ch'k'd	App'd

MOTT MACDONALD

Mott MacDonald House
8-10 Sydenham Road
Croydon, CR0 2EE
United Kingdom

T +44 (0)20 8774 2000
F +44 (0)20 8681 5706
W mottmac.com

Client

Brighton & Hove City Council

Title

A23 Active Travel Scheme
Preliminary Design
General Arrangement
Sheet 2 of 14

Designed	P. Crowther	PC	Eng check	...
Drawn	P. Crowther	PC	Coordination	...
Dwg check	J. Pearson	JP	Approved	N. Wilkinson
Scale at A1	Status	Rev	Security	
1:500	PRE	P3	STD	
Drawing Number				
100103332-MMD-00-XX-DR-HW-0002				



Image 1 - Example of bus border stop

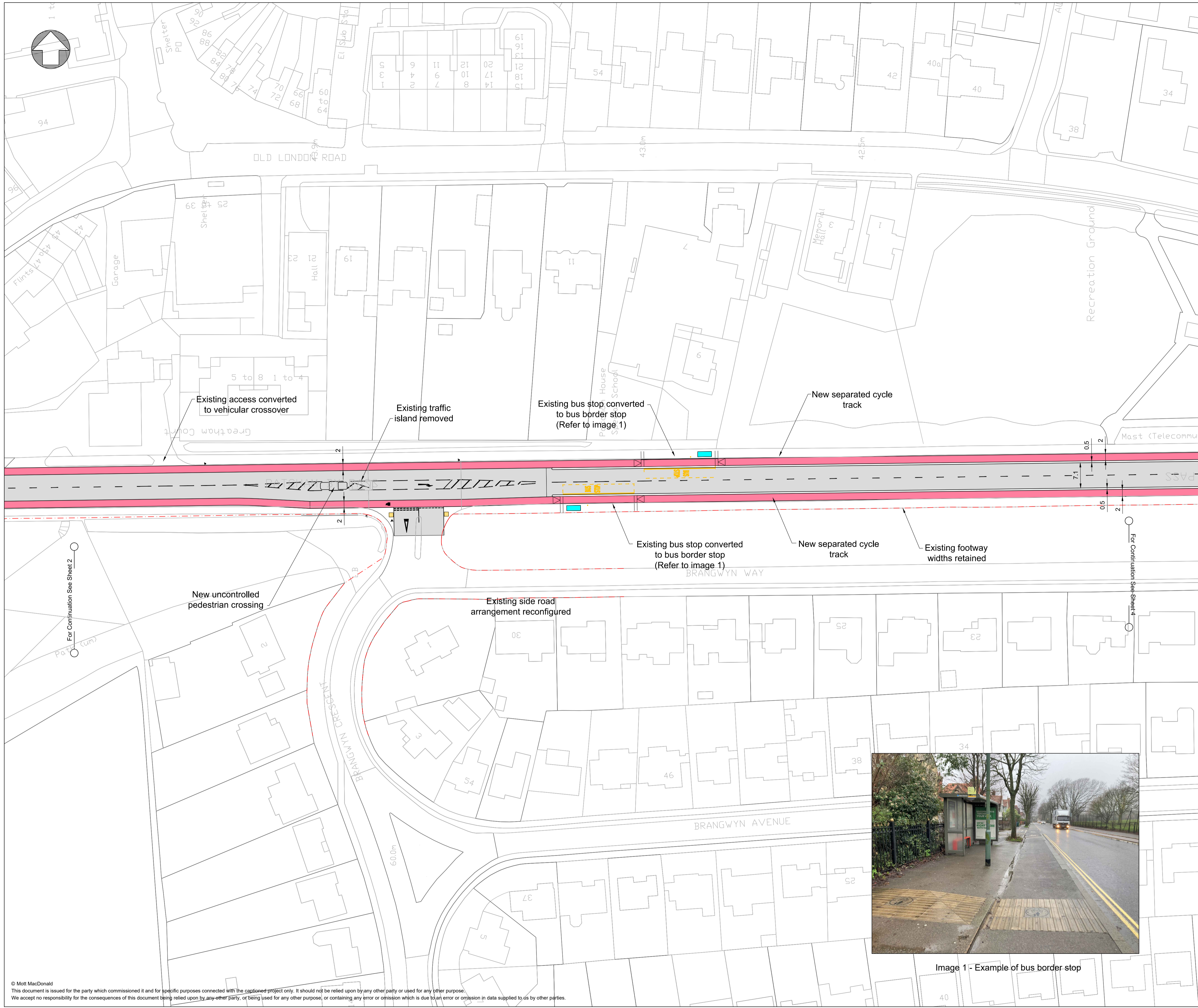

Notes
 1. Preliminary design has been developed using topographical survey information but presented with OS mapping background to provide further context. As such minor discrepancies between proposals and mapping background may be present.

Key to symbols

- Cycle Track/Lane
- Shared Use
- Carriageway
- Bus Lane
- Highway Boundary
- Traffic Sign

Reference drawings

P3	06.07.21	PJC	Drawing Amended	JP	NW
P2	02.07.21	PJC	Preliminary Design Issue	JP	NW
P1	25.06.21	PJC	Draft for Client Comment	XX	XX
Rev	Date	Drawn	Description	Ch'k'd	App'd

MOTT MACDONALD

Mott MacDonald House
 8-10 Sydenham Road
 Croydon, CR0 2EE
 United Kingdom

T +44 (0)20 8774 2000
 F +44 (0)20 8681 5706
 W mottmac.com



Title
 A23 Active Travel Scheme
 Preliminary Design
 General Arrangement
 Sheet 3 of 14

Designed	P. Crowther	PC	Eng check	...
Drawn	P. Crowther	PC	Coordination	...
Dwg check	J. Pearson	JP	Approved	N. Wilkinson
Scale at A1	Status	Rev	Security	
1:500	PRE	P3	STD	
Drawing Number 100103332-MMD-00-XX-DR-HW-0003				



Image 1 - Example of bus border stop

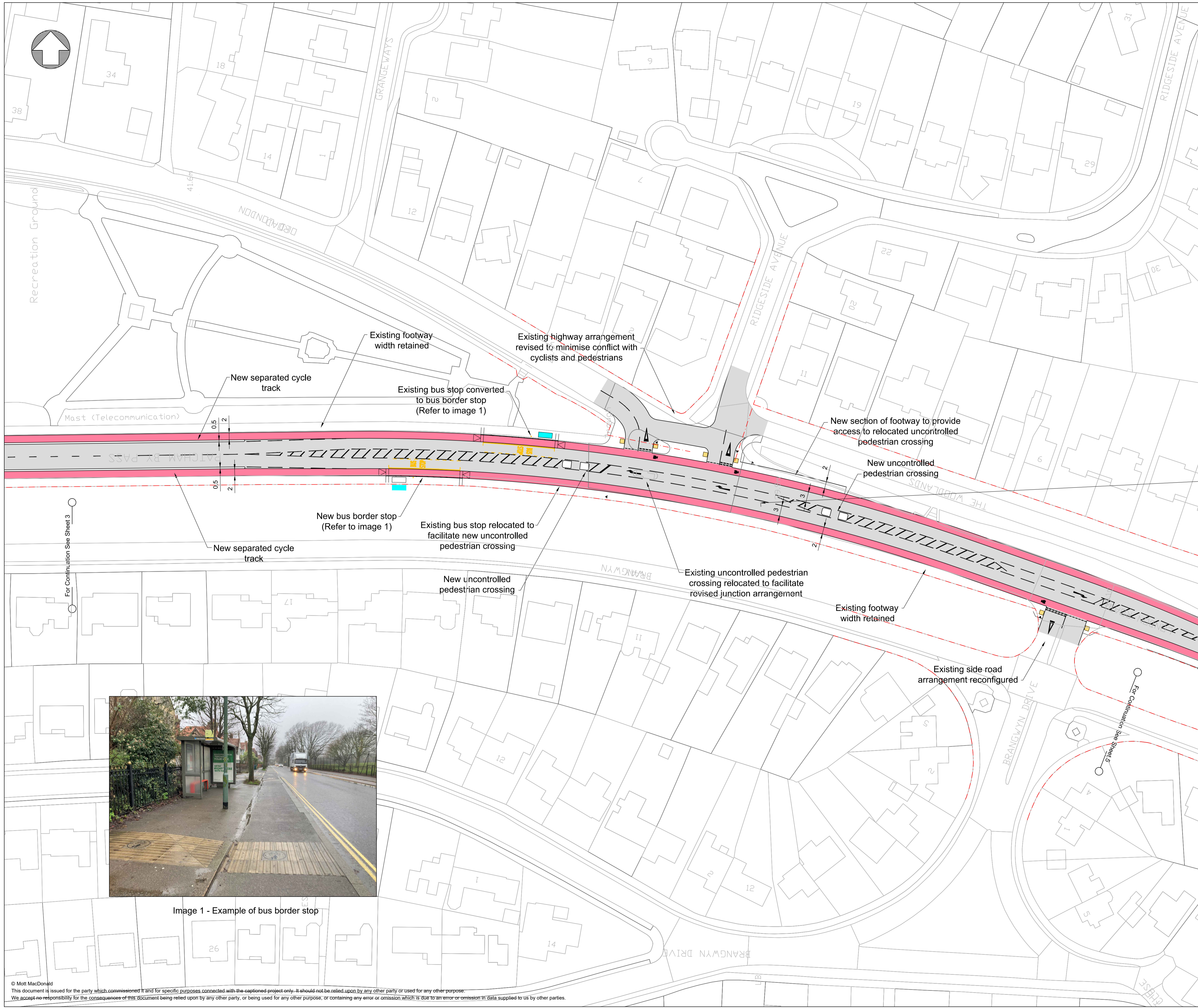

Notes
 1. Preliminary design has been developed using topographical survey information but presented with OS mapping background to provide further context. As such minor discrepancies between proposals and mapping background may be present.

Key to symbols

	Cycle Track/Lane
	Shared Use
	Carriageway
	Bus Lane
	Highway Boundary
	Traffic Sign

Reference drawings

P3	06.07.21	PJC	Drawing Amended	JP	NW
P2	02.07.21	PJC	Preliminary Design Issue	JP	NW
P1	25.06.21	PJC	Draft for Client Comment	XX	XX
Rev	Date	Drawn	Description	Ch'k'd	App'd

M M
MOTT MACDONALD

Mott MacDonald House
 8-10 Sydenham Road
 Croydon, CR0 2EE
 United Kingdom

T +44 (0)20 8774 2000
 F +44 (0)20 8681 5706
 W mottmac.com



Title
**A23 Active Travel Scheme
 Preliminary Design
 General Arrangement
 Sheet 4 of 14**

Designed	P. Crowther	PC	Eng check	...	
Drawn	P. Crowther	PC	Coordination	...	
Dwg check	J. Pearson	JP	Approved	N. Wilkinson	NW
Scale at A1	Status	Rev	Security		
1:500	PRE	P3	STD		
Drawing Number	100103332-MMD-00-XX-DR-HW-0004				



Image 1 - Example of bus border stop

© Mott MacDonald
 This document is issued for the party which commissioned it and for specific purposes connected with the captioned project only. It should not be relied upon by any other party or used for any other purpose.
 We accept no responsibility for the consequences of this document being relied upon by any other party, or being used for any other purpose, or containing any error or omission which is due to an error or omission in data supplied to us by other parties.

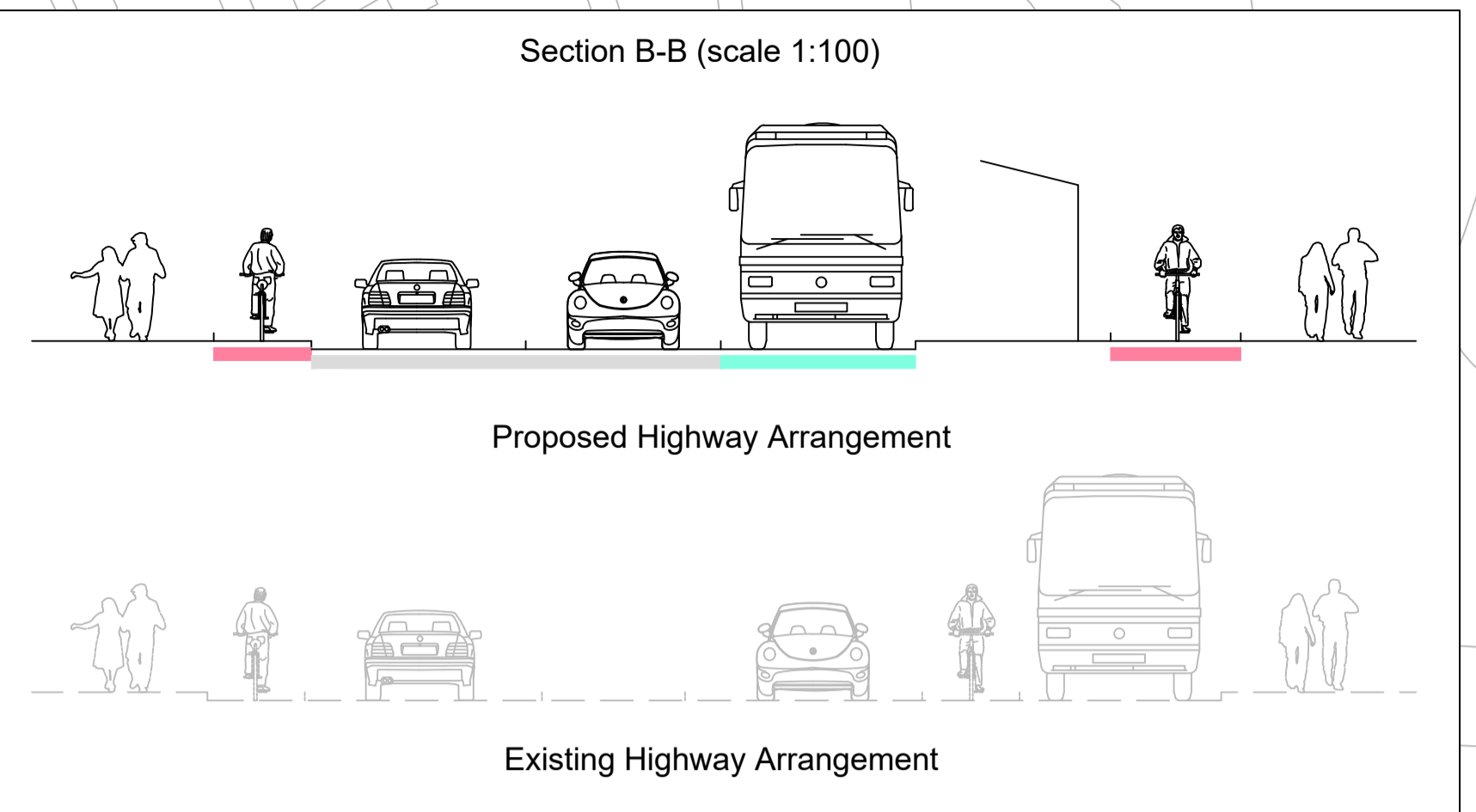

Notes
 1. Preliminary design has been developed using topographical survey information but presented with OS mapping background to provide further context. As such minor discrepancies between proposals and mapping background may be present.

Key to symbols

	Cycle Track/Lane
	Shared Use
	Carriageway
	Bus Lane
	Highway Boundary
	Traffic Sign

Reference drawings

P3	06.07.21	PJC	Drawing Amended	JP	NW
P2	02.07.21	PJC	Preliminary Design Issue	JP	NW
P1	25.06.21	PJC	Draft for Client Comment	XX	XX
Rev	Date	Drawn	Description	Ch'k'd	App'd

M M
MOTT MACDONALD

Mott MacDonald House
 8-10 Sydenham Road
 Croydon, CR0 2EE
 United Kingdom

T +44 (0)20 8774 2000
 F +44 (0)20 8681 5706
 W mottmac.com



Title
**A23 Active Travel Scheme
 Preliminary Design
 General Arrangement
 Sheet 5 of 14**

Designed	P. Crowther	PC	Eng check	...	
Drawn	P. Crowther	PC	Coordination	...	
Dwg check	J. Pearson	JP	Approved	N. Wilkinson	NW
Scale at A1	Status	Rev	Security		
1:500	PRE	P3	STD		

Drawing Number
100103332-MMD-00-XX-DR-HW-0005



Image 1 - Example of bus border stop

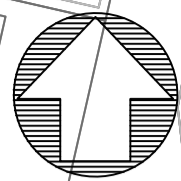
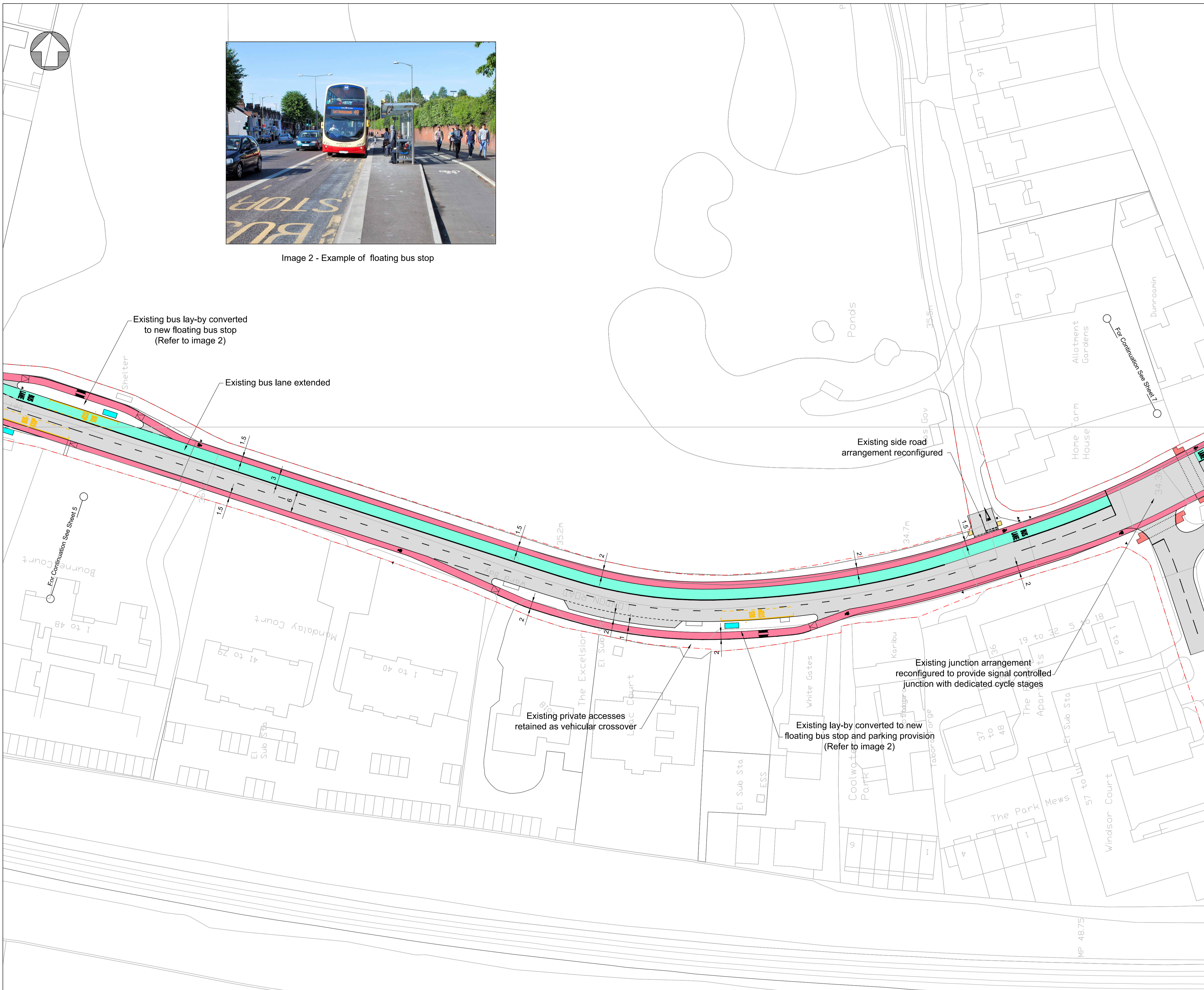

Image 2 - Example of floating bus stop



Notes
1. Preliminary design has been developed using topographical survey information but presented with OS mapping background to provide further context. As such minor discrepancies between proposals and mapping background may be present.

Key to symbols

- Cycle Track/Lane
- Shared Use
- Carriageway
- Bus Lane
- Highway Boundary
- Traffic Sign

Reference drawings

P3	06.07.21	PJC	Drawing Amended	JP	NW
P2	02.07.21	PJC	Preliminary Design Issue	JP	NW
P1	25.06.21	PJC	Draft for Client Comment	XX	XX
Rev	Date	Drawn	Description	Ch'k'd	App'd

M M
MOTT MACDONALD

Mott MacDonald House
8-10 Sydenham Road
Croydon, CR0 2EE
United Kingdom

T +44 (0)20 8774 2000
F +44 (0)20 8681 5706
W mottmac.com



Title
**A23 Active Travel Scheme
Preliminary Design
General Arrangement
Sheet 6 of 14**

Designed	P. Crowther	PC	Eng check	...
Drawn	P. Crowther	PC	Coordination	...
Dwg check	J. Pearson	JP	Approved	N. Wilkinson

Scale at A1	Status	Rev	Security
1:500	PRE	P3	STD

Drawing Number
100103332-MMD-00-XX-DR-HW-0006

© Mott MacDonald
This document is issued for the party which commissioned it and for specific purposes connected with the captioned project only. It should not be relied upon by any other party or used for any other purpose.
We accept no responsibility for the consequences of this document being relied upon by any other party, or being used for any other purpose, or containing any error or omission which is due to an error or omission in data supplied to us by other parties.

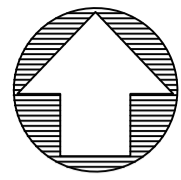
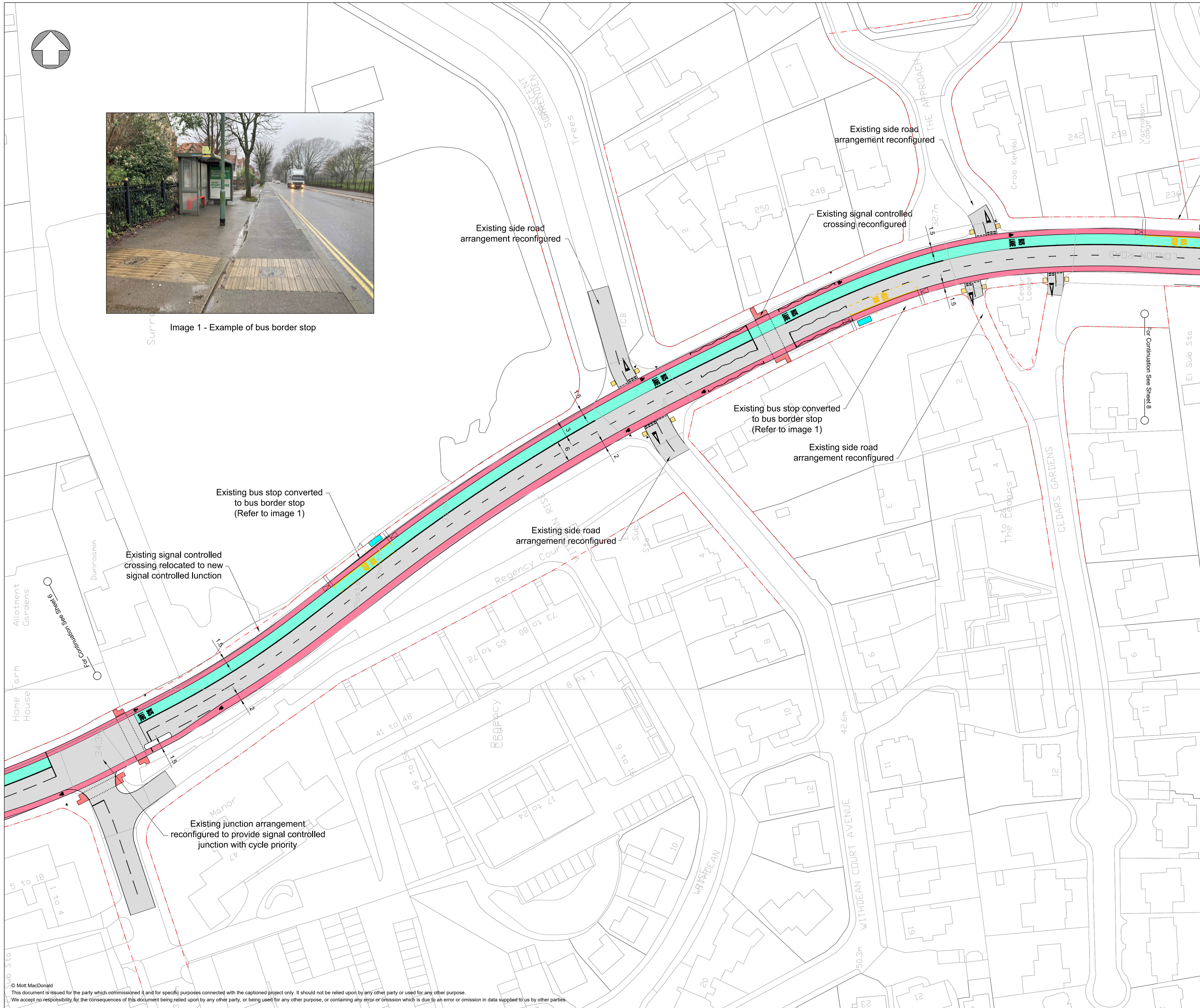

Image 1 - Example of bus border stop



Notes
1. Preliminary design has been developed using topographical survey information but presented with OS mapping background to provide further context. As such minor discrepancies between proposals and mapping background may be present.

Key to symbols

- Cycle Track/Lane
- Shared Use
- Carriageway
- Bus Lane
- Highway Boundary
- Traffic Sign

Reference drawings

Rev	Date	Drawn	Description	Ch'k'd	App'd
P3	06.07.21	PJC	Drawing Amended	JP	NW
P2	02.07.21	PJC	Preliminary Design Issue	JP	NW
P1	25.06.21	PJC	Draft for Client Comment	XX	XX

M M
MOTT MACDONALD

Mott MacDonald House
8-10 Sydenham Road
Croydon, CR0 2EE
United Kingdom

T +44 (0)20 8774 2000
F +44 (0)20 8681 5706
W mottmac.com

Client

Brighton & Hove City Council

Title
**A23 Active Travel Scheme
Preliminary Design
General Arrangement
Sheet 7 of 14**

Designed	P. Crowther	PC	Eng check	...
Drawn	P. Crowther	PC	Coordination	...
Dwg check	J. Pearson	JP	Approved	N. Wilkinson
Scale at A1	Status	Rev	Security	
1:500	PRE	P3	STD	

Drawing Number
100103332-MMD-00-XX-DR-HW-0007

© Mott MacDonald
This document is issued for the party which commissioned it and for specific purposes connected with the captioned project only. It should not be relied upon by any other party or used for any other purpose.
We accept no responsibility for the consequences of this document being relied upon by any other party, or being used for any other purpose, or containing any error or omission which is due to an error or omission in data supplied to us by other parties.
C:\Users\CRO91066\Mott MacDonald\BHCC Design and Transport Fram - Acad\IDR\103332-MMD-DD-XX-DR-HW-0007 P3 sheet 7 of 14.dwg Jul 6, 2021 - 3:43PM CRO91066

223

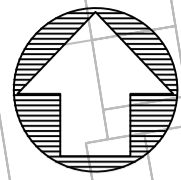

Image 1 - Example of bus border stop

Notes
1. Preliminary design has been developed using topographical survey information but presented with OS mapping background to provide further context. As such minor discrepancies between proposals and mapping background may be present.

Key to symbols

- Cycle Track/Lane
- Shared Use
- Carriageway
- Bus Lane
- Highway Boundary
- Traffic Sign

Reference drawings

Rev	Date	Drawn	Description	Ch'k'd	App'd
P3	06.07.21	PJC	Drawing Amended	JP	NW
P2	02.07.21	PJC	Preliminary Design Issue	JP	NW
P1	25.06.21	PJC	Draft for Client Comment	XX	XX

M M
MOTT MACDONALD

Mott MacDonald House
8-10 Sydenham Road
Croydon, CR0 2EE
United Kingdom

T +44 (0)20 8774 2000
F +44 (0)20 8681 5706
W mottmac.com



Title
**A23 Active Travel Scheme
Preliminary Design
General Arrangement
Sheet 8 of 14**

Designed	P. Crowther	PC	Eng check	...
Drawn	P. Crowther	PC	Coordination	...
Dwg check	J. Pearson	JP	Approved	N. Wilkinson NW

Scale at A1	Status	Rev	Security
1:500	PRE	P3	STD

Drawing Number
100103332-MMD-00-XX-DR-HW-0008

224

© Mott MacDonald
This document is issued for the party which commissioned it and for specific purposes connected with the captioned project only. It should not be relied upon by any other party or used for any other purpose.
We accept no responsibility for the consequences of this document being relied upon by any other party, or being used for any other purpose, or containing any error or omission which is due to an error or omission in data supplied to us by other parties.

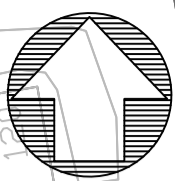
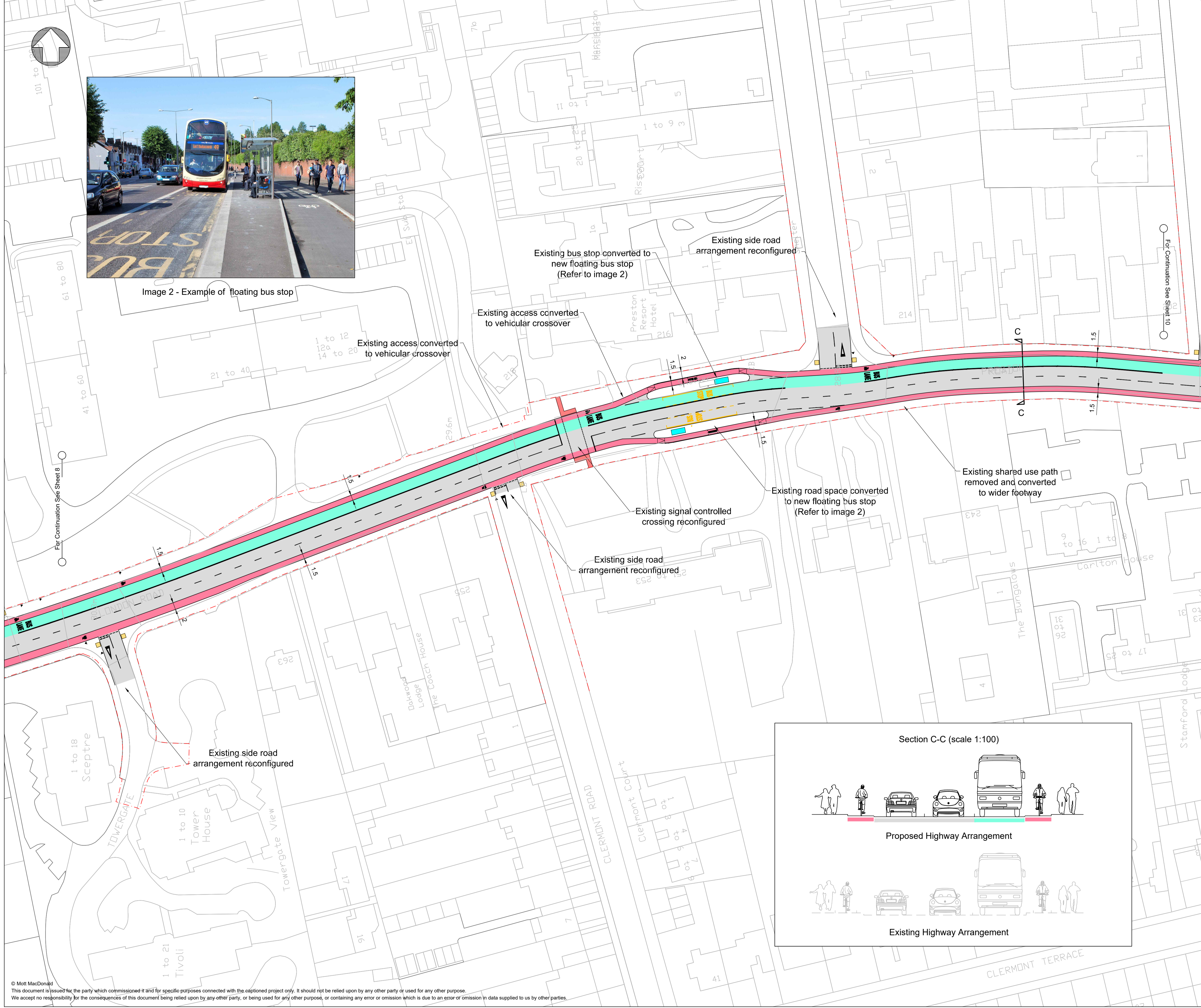

Image 2 - Example of floating bus stop



Notes

1. Preliminary design has been developed using topographical survey information but presented with OS mapping background to provide further context. As such minor discrepancies between proposals and mapping background may be present.

Key to symbols

- Cycle Track/Lane
- Shared Use
- Carriageway
- Bus Lane
- Highway Boundary
- Traffic Sign

Reference drawings

Rev	Date	Drawn	Description	Ch'k'd	App'd
P3	06.07.21	PJC	Drawing Amended	JP	NW
P2	02.07.21	PJC	Preliminary Design Issue	JP	NW
P1	25.06.21	PJC	Draft for Client Comment	XX	XX

MOTT MACDONALD

Mott MacDonald House
8-10 Sydenham Road
Croydon, CR0 2EE
United Kingdom

T +44 (0)20 8774 2000
F +44 (0)20 8681 5706
W mottmac.com



Title

A23 Active Travel Scheme
Preliminary Design
General Arrangement
Sheet 9 of 14

Designed	P. Crowther	PC	Eng check	...
Drawn	P. Crowther	PC	Coordination	...
Dwg check	J. Pearson	JP	Approved	N. Wilkinson
Scale at A1	1:500	Status	PRE	Rev P3
Drawing Number	100103332-MMD-00-XX-DR-HW-0009			

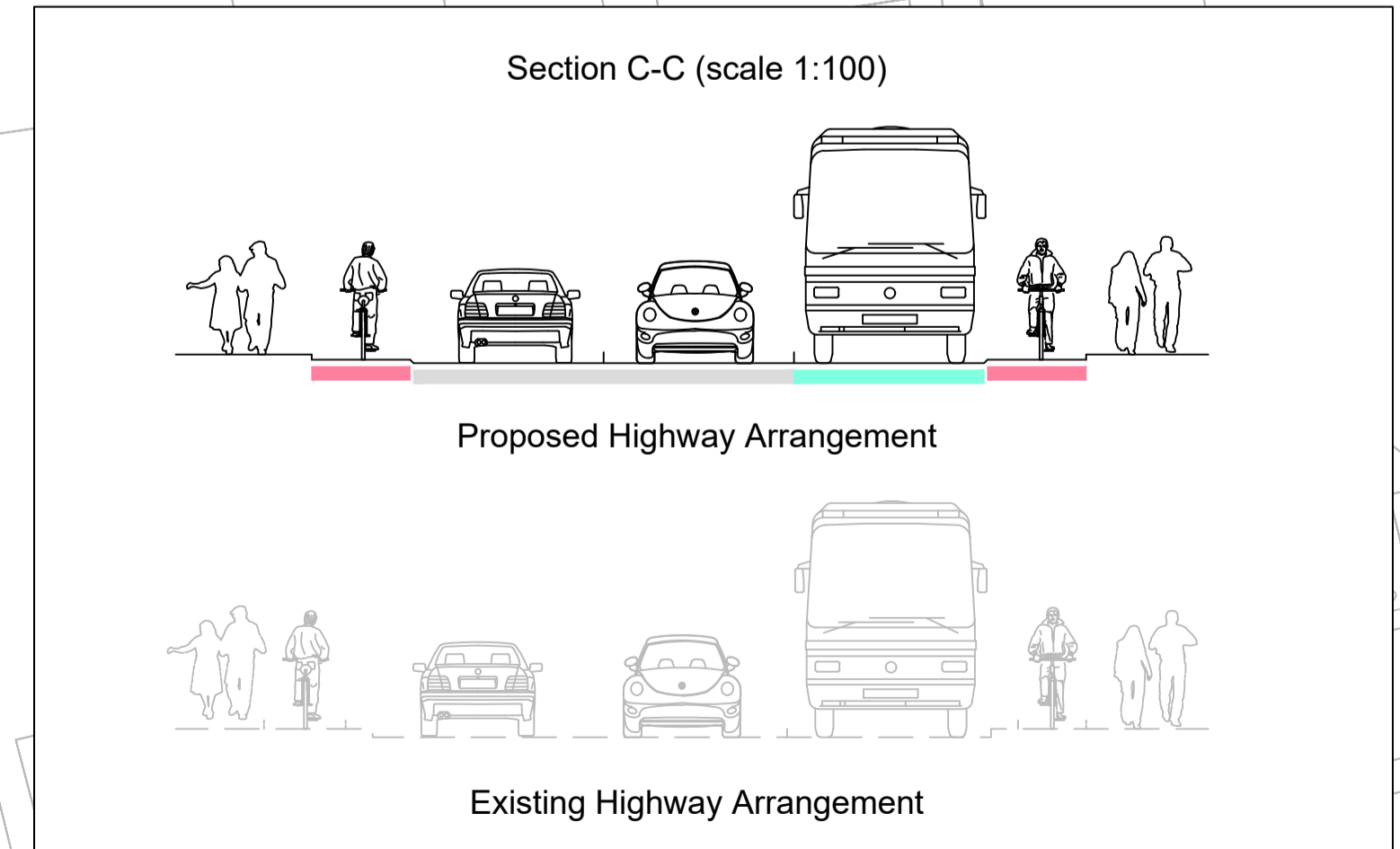

© Mott MacDonald
This document is issued for the party which commissioned it and for specific purposes connected with the captioned project only. It should not be relied upon by any other party or used for any other purpose.
We accept no responsibility for the consequences of this document being relied upon by any other party, or being used for any other purpose, or containing any error or omission which is due to an error or omission in data supplied to us by other parties.



Image 2 - Example of floating bus stop

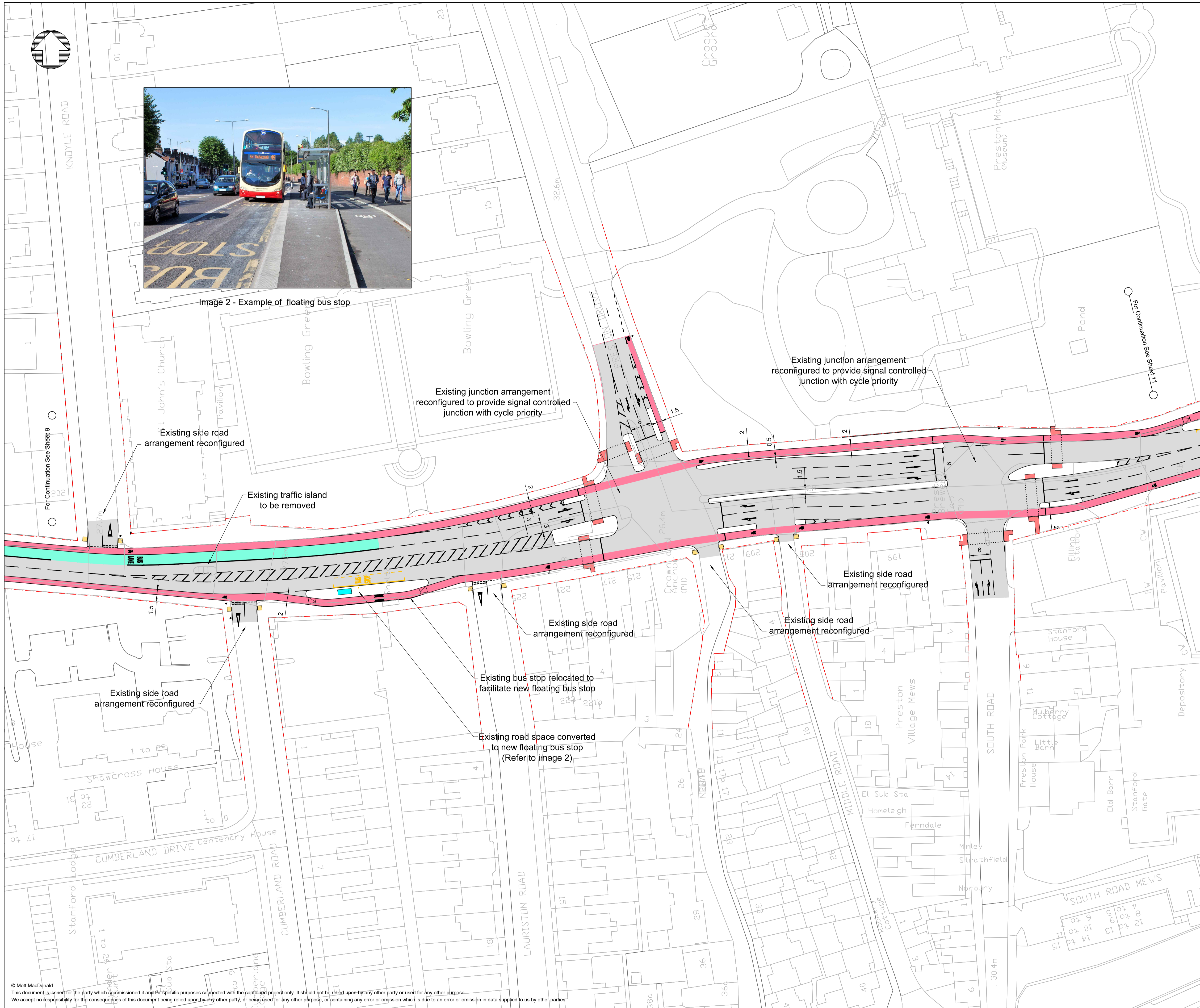

Notes

- Preliminary design has been developed using topographical survey information but presented with OS mapping background to provide further context. As such minor discrepancies between proposals and mapping background may be present.

Key to symbols

- Cycle Track/Lane
- Shared Use
- Carriageway
- Bus Lane
- Highway Boundary
- Traffic Sign

Reference drawings

Rev	Date	Drawn	Description	Ch'k'd	App'd
P4	06.07.21	PJC	Drawing Amended	JP	NW
P3	05.07.21	PJC	Tactile Paving Amended	JP	NW
P2	02.07.21	PJC	Preliminary Design Issue	JP	NW
P1	25.06.21	PJC	Draft for Client Comment	XX	XX

MOTT MACDONALD

Mott MacDonald House
8-10 Sydenham Road
Croydon, CR0 2EE
United Kingdom

T +44 (0)20 8774 2000
F +44 (0)20 8681 5706
W mottmac.com

Brighton & Hove City Council

Title
A23 Active Travel Scheme
Preliminary Design
General Arrangement
Sheet 10 of 14

Designed	P. Crowther	PC	Eng check	...
Drawn	P. Crowther	PC	Coordination	...
Dwg check	J. Pearson	JP	Approved	N. Wilkinson
Scale at A1	1:500	Status	PRE	Rev P4
Security	STD			
Drawing Number 100103332-MMD-00-XX-DR-HW-0010				

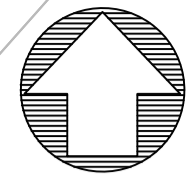

Image 1 - Example of bus border stop



Image 2 - Example of floating bus stop



Notes

1. Preliminary design has been developed using topographical survey information but presented with OS mapping background to provide further context. As such minor discrepancies between proposals and mapping background may be present.

Key to symbols

	Cycle Track/Lane
	Shared Use
	Carriageway
	Bus Lane
	Highway Boundary
	Traffic Sign

Reference drawings

P3	06.07.21	PJC	Drawing Amended	JP	NW
P2	02.07.21	PJC	Preliminary Design Issue	JP	NW
P1	25.06.21	PJC	Draft for Client Comment	XX	XX
Rev	Date	Drawn	Description	Ch'k'd	App'd

M M
MOTT MACDONALD

Mott MacDonald House
8-10 Sydenham Road
Croydon, CR0 2EE
United Kingdom

T +44 (0)20 8774 2000
F +44 (0)20 8681 5706
W mottmac.com

Client

Brighton & Hove City Council

Title

**A23 Active Travel Scheme
Preliminary Design
General Arrangement
Sheet 11 of 14**

Designed	P. Crowther	PC	Eng check	...	
Drawn	P. Crowther	PC	Coordination	...	
Dwg check	J. Pearson	JP	Approved	N. Wilkinson	NW
Scale at A1	Status	Rev	Security		
1:500	PRE	P3	STD		
Drawing Number					
100103332-MMD-00-XX-DR-HW-0011					

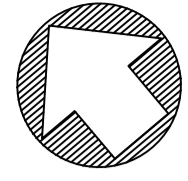

Image 1 - Example of bus border stop

Notes
1. Preliminary design has been developed using topographical survey information but presented with OS mapping background to provide further context. As such minor discrepancies between proposals and mapping background may be present.

Key to symbols

- Cycle Track/Lane
- Shared Use
- Carriageway
- Bus Lane
- Highway Boundary
- Traffic Sign

Reference drawings

P3	06.07.21	PJC	Drawing Amended	JP	NW
P2	02.07.21	PJC	Preliminary Design Issue	JP	NW
P1	25.06.21	PJC	Draft for Client Comment	XX	XX
Rev	Date	Drawn	Description	Ch'k'd	App'd

M M
MOTT MACDONALD

Mott MacDonald House
8-10 Sydenham Road
Croydon, CR0 2EE
United Kingdom

T +44 (0)20 8774 2000
F +44 (0)20 8681 5706
W mottmac.com



Title
**A23 Active Travel Scheme
Preliminary Design
General Arrangement
Sheet 12 of 14**

Designed	P. Crowther	PC	Eng check	...
Drawn	P. Crowther	PC	Coordination	...
Dwg check	J. Pearson	JP	Approved	N. Wilkinson
Scale at A1	1:500	Status	PRE	Rev P3
Drawing Number	100103332-MMD-00-XX-DR-HW-0012			

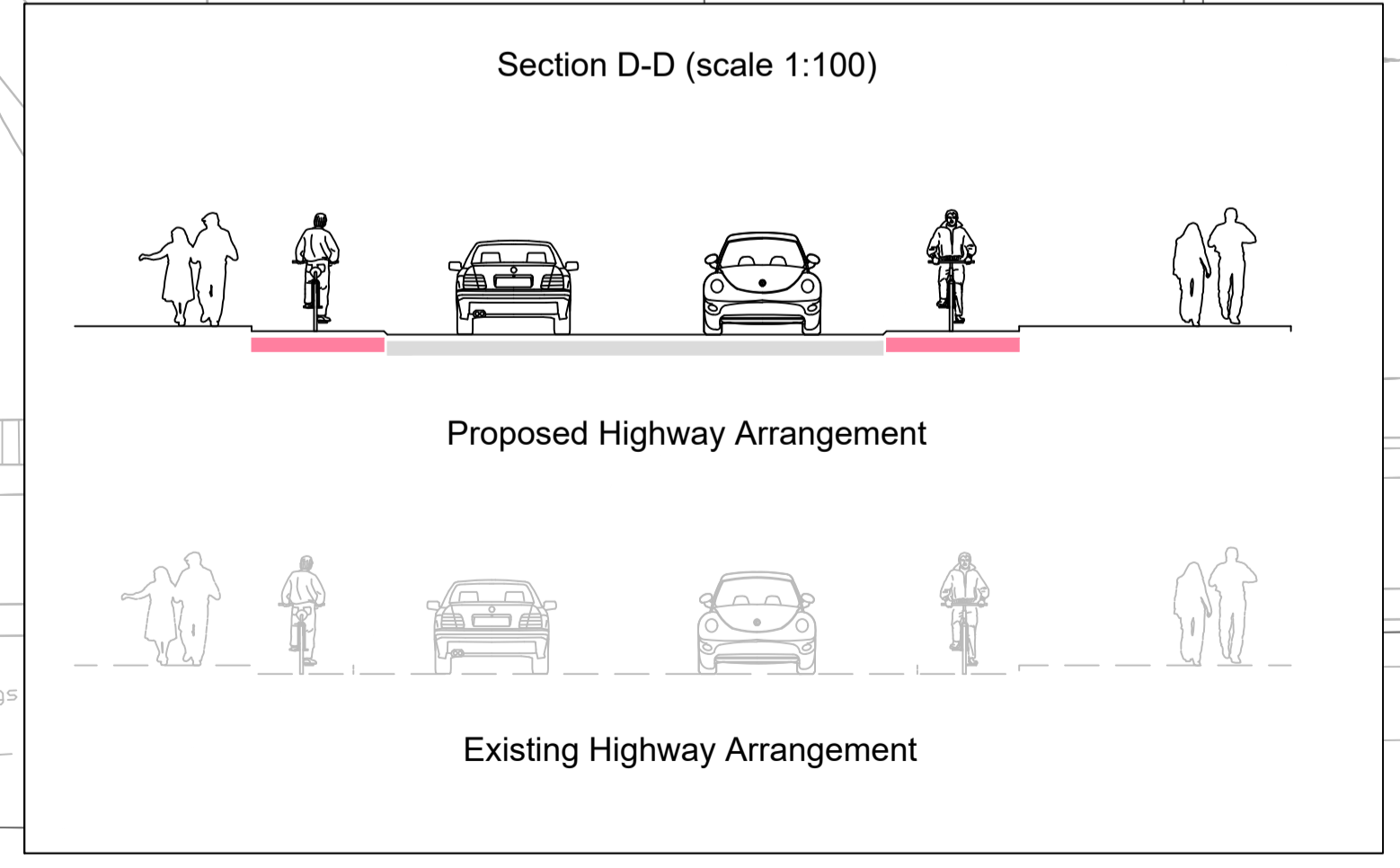
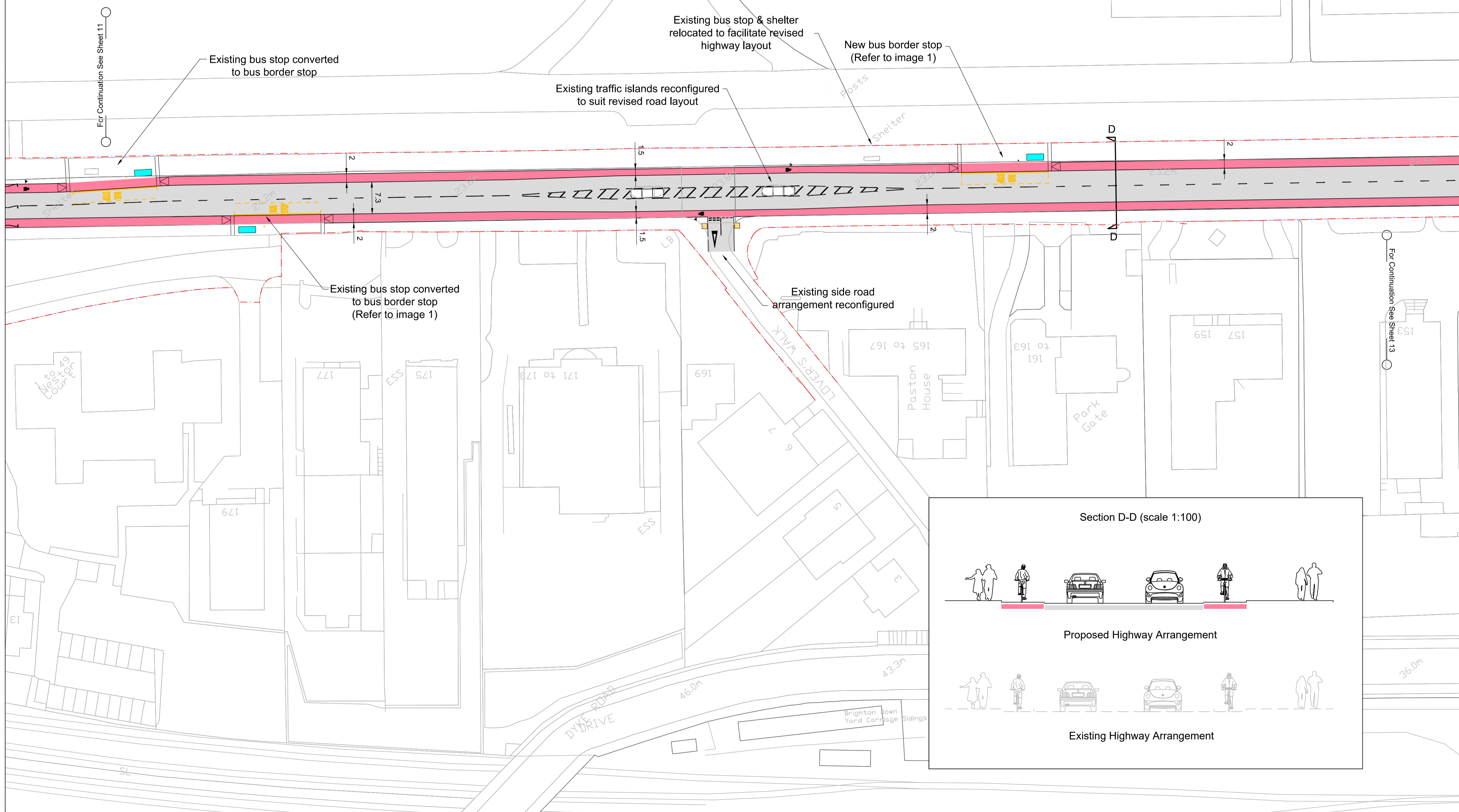

© Mott MacDonald
This document is issued for the party which commissioned it and for specific purposes connected with the captioned project only. It should not be relied upon by any other party or used for any other purpose.
We accept no responsibility for the consequences of this document being relied upon by any other party, or being used for any other purpose, or containing any error or omission which is due to an error or omission in data supplied to us by other parties.

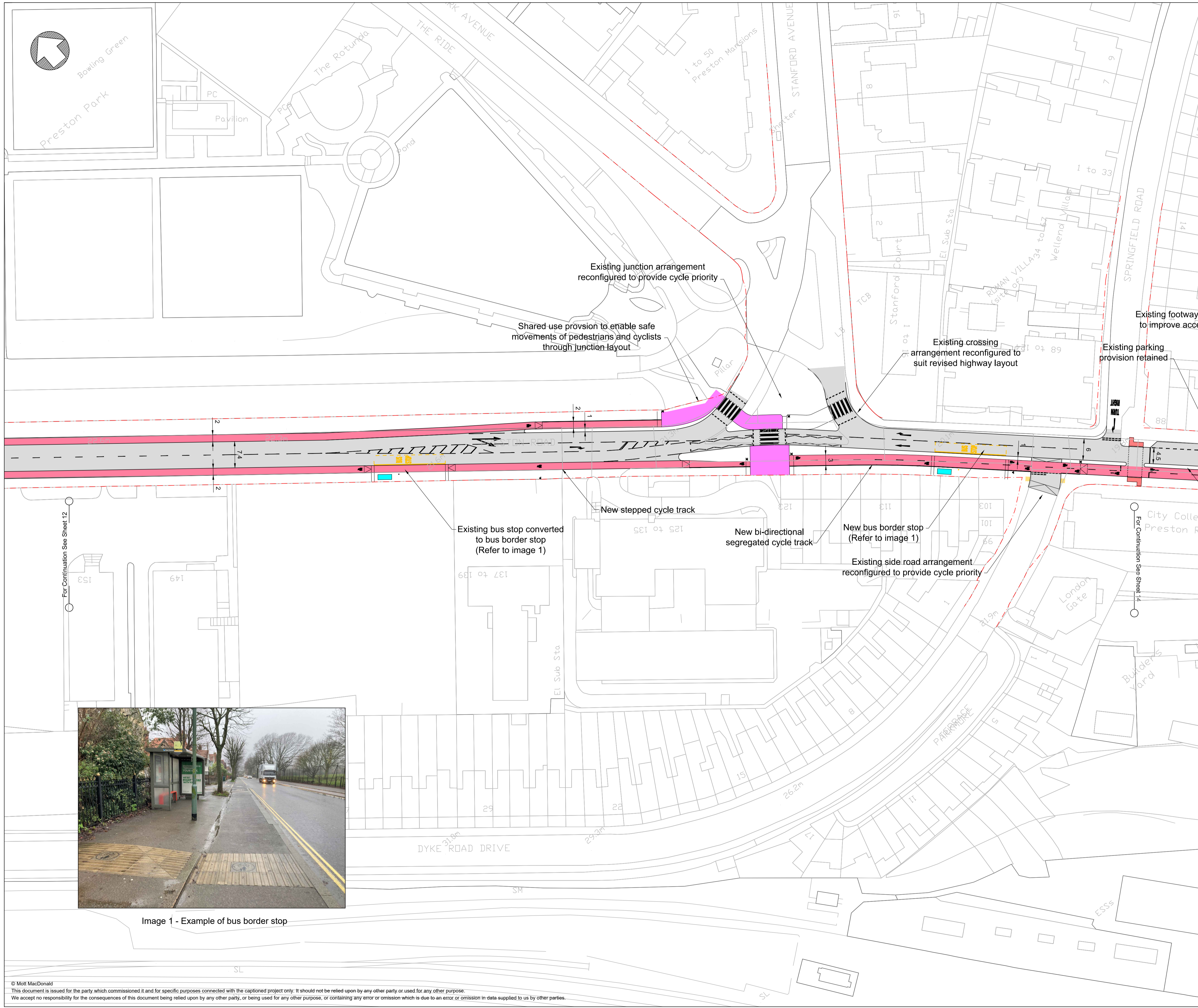

Notes

1. Preliminary design has been developed using topographical survey information but presented with OS mapping background to provide further context. As such minor discrepancies between proposals and mapping background may be present.

Key to symbols

- Cycle Track/Lane
- Shared Use
- Carriageway
- Bus Lane
- Highway Boundary
- Traffic Sign

Reference drawings

Rev	Date	Drawn	Description	Ch'k'd	App'd
P3	06.07.21	PJC	Drawing Amended	JP	NW
P2	02.07.21	PJC	Preliminary Design Issue	JP	NW
P1	25.06.21	PJC	Draft for Client Comment	XX	XX

M M
MOTT MACDONALD

Mott MacDonald House
8-10 Sydenham Road
Croydon, CR0 2EE
United Kingdom

T +44 (0)20 8774 2000
F +44 (0)20 8681 5706
W mottmac.com

Client

Brighton & Hove City Council

Title

**A23 Active Travel Scheme
Preliminary Design
General Arrangement
Sheet 13 of 14**

Designed	P. Crowther	PC	Eng check	...
Drawn	P. Crowther	PC	Coordination	...
Dwg check	J. Pearson	JP	Approved	N. Wilkinson NW
Scale at A1	Status	Rev	Security	
1:500	PRE	P3	STD	

Drawing Number
100103332-MMD-00-XX-DR-HW-0013



Image 1 - Example of bus border stop

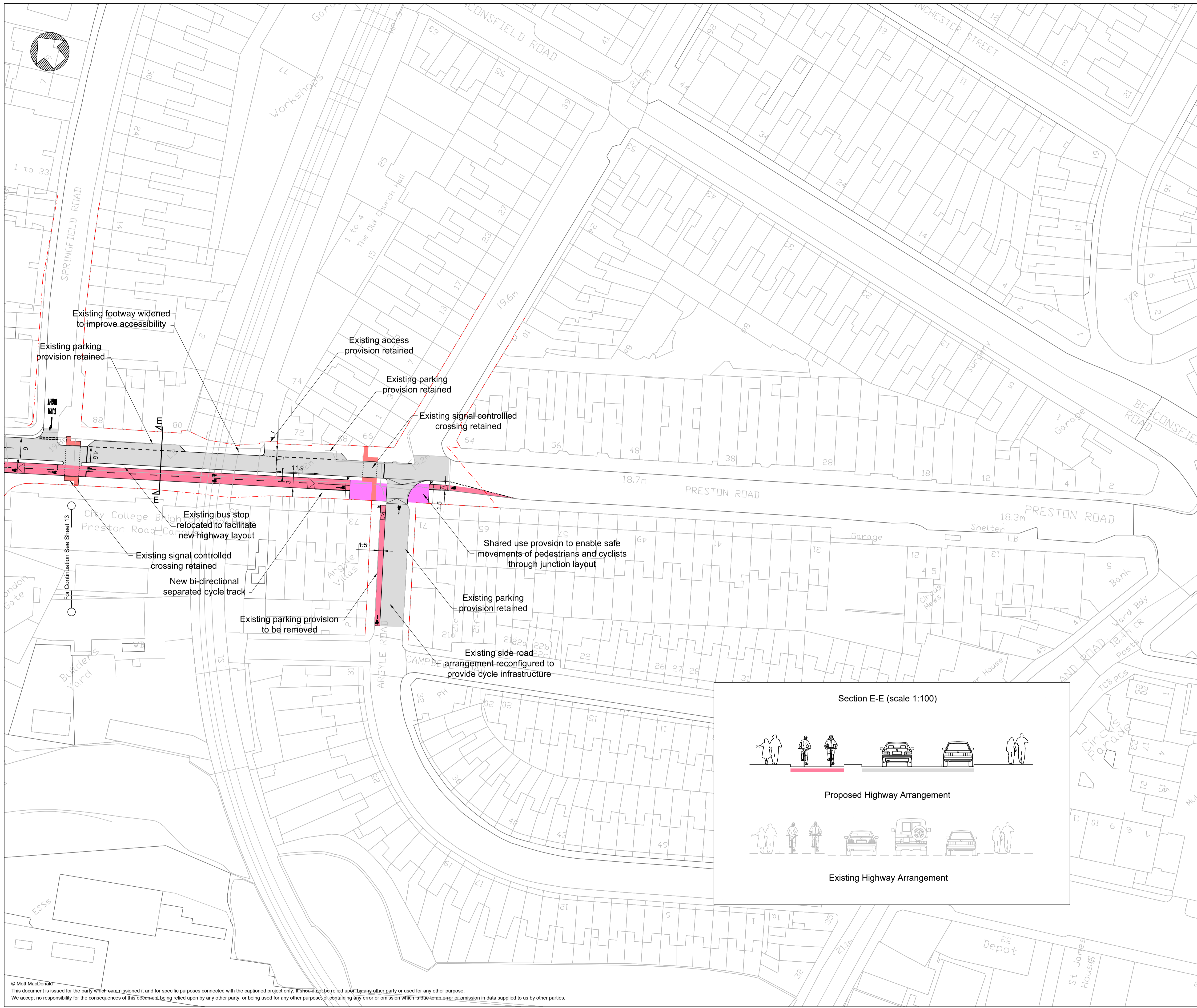

Notes
 1. Preliminary design has been developed using topographical survey information but presented with OS mapping background to provide further context. As such minor discrepancies between proposals and mapping background may be present.

Key to symbols

	Cycle Track/Lane
	Shared Use
	Carriageway
	Bus Lane
	Highway Boundary
	Traffic Sign

Reference drawings

Rev	Date	Drawn	Description	Ch'k'd	App'd
P3	06.07.21	PJC	Drawing Amended	JP	NW
P2	02.07.21	PJC	Preliminary Design Issue	JP	NW
P1	25.06.21	PJC	Draft for Client Comment	XX	XX

MOTT MACDONALD

Mott MacDonald House
 8-10 Sydenham Road
 Croydon, CR0 2EE
 United Kingdom

T +44 (0)20 8774 2000
 F +44 (0)20 8681 5706
 W mottmac.com

Client

Brighton & Hove City Council

Title
 A23 Active Travel Scheme
 Preliminary Design
 General Arrangement
 Sheet 14 of 14

Designed	P. Crowther	PC	Eng check	...
Drawn	P. Crowther	PC	Coordination	...
Dwg check	J. Pearson	JP	Approved	N. Wilkinson
Scale at A1	Status	Rev	Security	
1:500	PRE	P3	STD	
Drawing Number 100103332-MMD-00-XX-DR-HW-0014				

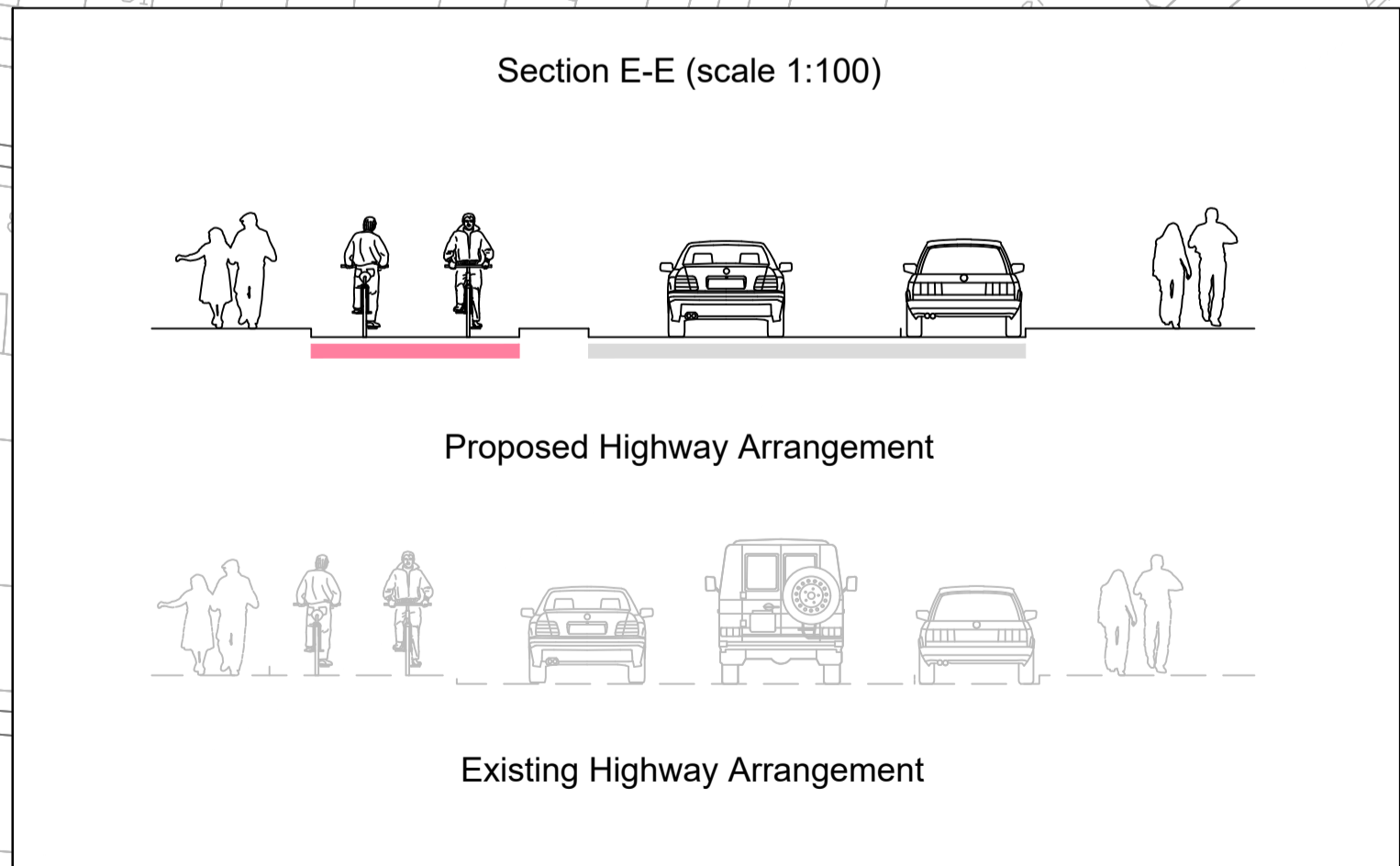

© Mott MacDonald
 This document is issued for the party which commissioned it and for specific purposes connected with the captioned project only. It should not be relied upon by any other party or used for any other purpose.
 We accept no responsibility for the consequences of this document being relied upon by any other party, or being used for any other purpose, or containing any error or omission which is due to an error or omission in data supplied to us by other parties.

C:\Users\CR01066\Mott MacDonald\BHC Design and Transport Fram - Acad\DR\103332-MMD-DD-XX-DR-HW-0014 P3 sheet 14 of 14.dwg Jul 6, 2021 - 4:25PM CRO91066